



BOTSWANA



2013

Discover the Real Africa with us

Karibu Safari

Botswana is seen as the last True Wilderness on Earth and offers what money cannot buy...unique and diverse habitats, epic sunsets and vast areas of undisturbed wilderness. The land where wildlife freely follow their migratory paths. Botswana is a large country, about the size of France, scantily populated with less than 1.8 mil inhabitants. Most settlements are situated along the South, eastern border of the country with few people in the central and northern regions.

The Batswana are a friendly people and respect the rule of law, crime is minimal, and we remain the most politically stable country in Africa. Tourism is recognised as a key economic contributor and is favoured as a sustainable income for future generations.

The Okavango Delta forms the world's largest oasis as the fresh waters from the Angola highlands spill across the Kalahari Desert. This vast Eden is home to Africa's diverse animal populations and is the setting for your future explorations and adventure with Karibu Safari.

Accept no compromise, insist on a Karibu Safari. Discover the Real Africa with us.



Who is Karibu?

Karibu Safari is a reputable, well established safari company that has been organizing African Safari vacations in Southern Africa since 1983. Over the past 28 years our dedication to well planned safaris has secured us international reputation of "Leading Safari operator in Southern Africa".

At Karibu Safari, many years and miles of experience have enabled us to achieve that perfect balance between a true African safari and the superior level of comfort and consideration which makes your journey truly memorable. We are inordinately proud of what we have to offer you... the finest safari in Africa!!

Credits

Photography: James Munro - james.p.munro@gmail.com, Trevor Kleyn - www.trevorkleyn.com, Teresa Moore, Christian Deffense, Darren Locke, Siggie Anton, Liza Smith
Design: Teresa Moore terry@gmail.co.za

Welcomes you to Africa

Facts about Botswana

* Republic of Botswana

Botswana became an independent country on 30 September 1966. It is a multi-party democracy, governed by an Executive President. The current President is His Excellency Lieutenant General Seretse Khama Ian Khama.

* Population

The total population is estimated at 1.85 million growing at a rate of 3.5% per annum.

* Language

The official language is English, which is used in government and business. Setswana is the national language and is widely spoken. Other ethnic groups speak their own languages.

* Climate

Summer: December to March. High temperatures average 30C to 35C with lows around 18C. Rain particularly in December to February.
Winter: June to August. Daytime temperatures around 23C with night time lows averaging 5C.

* Geography

Botswana's surface area consists of 581,730 sq km. Botswana is completely landlocked, bordered by its neighbours South Africa, Namibia, Zambia and Zimbabwe.

* Currency

Botswana's currency is the Pula. The Pula is divided into 100 thebe.

Notes - P200, P100, P20 and P10.

Coins - P5, P2 and P1. Thebe - 50t, 25t, 10t and 5t.



Standard Mobile Safaris

- Kalahari Migration Safari Page 6
- Authentic Safari Page 7
- Okavango Safari Page 8
- Desert and Delta Adventure.. Page 9



Standard Mobile Safari in exclusive camps through Botswana. Allow the safari crew to set up camp, prepare hearty meals for you and expertly guide you through the African Bushveld

GROUP SIZE

- * 2 – 8 clients per vehicle (2 vehicles may
 - * travel together on certain departures).
- * Scheduled departures.
- * Private tailor-made safaris on offer between November and June.

TENTS AND EQUIPMENT

- * 2 person spacious dome tent (L3m x W3m x H2.20m) with built in groundsheet, 2 large aerating windows with mosquito netting. 2 camp beds with high density foam mattress, bed linen and pillow.
- * "Alfresco" en-suite bathroom (2m x 3m) with warm bucket shower, bath towel, hand towel, hand basin and porta-potti toilet.
- * A large canvas canopy (5m x 5m) is used as a dining area.

STANDARD MOBILE SAFARI DOME TENT

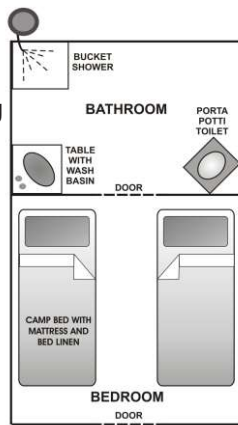

FOOD AND DRINKS

- * 3 wholesome meals each day.
- * Tea and coffee available in camp.
- * Mineral water is provided.

Not Included: Alcoholic beverages and soft drinks, these can be purchased at the start of the safari or pre-ordered.

VEHICLES

- * Open sided 4 x 4 Toyota Land Cruiser or Land Rover, ideal for game viewing.
- * Cooler boxes and battery charging facilities on all vehicles.

STAFF

- * Guide, chef and camp assistants.



Comfort Mobile Safaris

- Stanley Safari..... Page 10
- Classic Moremi Safari..... Page 11
- Lilies & Dust Safari Page 12 & 13
- Unique Wilderness..... Page 14



A Comfort Mobile Safari hosted in secluded, exclusive bush camps in the famous Botswana Reserves and National Parks. Safari crews Pre-erect the comfortable camp, a professional Safari guide conducts early morning and late afternoon game drives and an experienced chef prepares delicious bush cuisine meals.

GROUP SIZE

- * 2-8 clients per vehicle (2 vehicles may travel together).
- * Scheduled departures, or any date on any private tailor made safaris between November and June.

TENTS AND EQUIPMENT

- * 2 person comfortable dome tent. (L3m x W3m x H2.20m) with built in groundsheet, 2 large aerating windows with mosquito netting.
- * En-suite bathroom (L1.5 x W3m x H2.20m) with warm bucket shower, towels, hand basin, mirror and flush toilet.
- * 2 comfortable camp beds with superior mattresses, linen, duvets, pillows and blankets.
- * Safari folding chair.
- * A large marquee tent (5m x 5m) is used for shade.

COMFORT MOBILE SAFARI DOME TENT

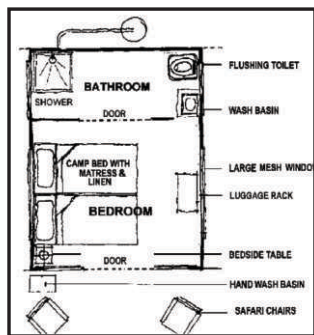

FOOD AND DRINKS

- * 3 delicious meals each day - with a three course dinner served 'Al fresco' under the stars.
- * Tea and coffee available in camp.
- * South African wine is served in the evening during dinner when in camp.
- * Mineral water is provided.
- * **Not included:** Alcoholic beverages and soft drinks. These can be pre-ordered.

VEHICLES

- * Open sided 4x4 Toyota land cruiser, ideal for game viewing.
- * All game drives are guaranteed with window seats, fridges and battery charging facilities on all vehicles.

STAFF

- * Guide, chef and 2-4 camps staff.



Kalahari Migration Safari

Botswana 9 Days

7 NIGHTS STANDARD MOBILE SAFARI WITH 1 NIGHT COMFORT LODGE ACCOMMODATION



Day 1: Maun to Nxai Pan

We are met at the airport by our guide and road transferred to our first campsite in Nxai Pan. A packed lunch is provided en-route. After a sunset game drive a delicious wholesome meal is enjoyed. Standard Mobile Safari **(Packed lunch & dinner)**



Day 8: Central Kalahari

Today we are transferred by our guide to the lodge. We have time to relax, enjoy sundowners and dinner before taking a night drive to explore the magic of the nocturnal creatures in the area. Haina Kalahari Lodge (or similar accommodation) **(All meals)**



Day 3 & 4: Makgadikgadi National Park

Our safari crew expertly moves our camp to the Makgadikgadi National Park, where we continue to seek the migrating herds of Zebra & Wildebeest. Standard Mobile Safari **(All meals)**



Day 2: Nxai Pan National Park

After breakfast we take a leisure game drive and visit the Baines Baobab's. This area is home to a variety of unique wildlife and provides us with the opportunity to spot Bat-eared Fox, Springbok and Wild dog. Standard Mobile Safari **(All meals)**



Day 9: Maun

After an early rise we will take our last memorable game drive, before breakfast. A flight then transfers us back to Maun airport. **(Breakfast)**



Day 5, 6 & 7: Central Kalahari Game Reserve

An early morning game drive takes us to the unique and special Central Kalahari Reserve with the opportunity to encounter the majestic Black-maned Kalahari Lions. Like us, these and a host of other predators are pursuing the migratory herds. Standard Mobile Safari **(All meals)**



Transfers Included: Day 1 - road transfer from Maun to Nxai Pan
Day 9 - Charter flight from Central Kalahari to Maun

Tour Code: KM Maun to Maun

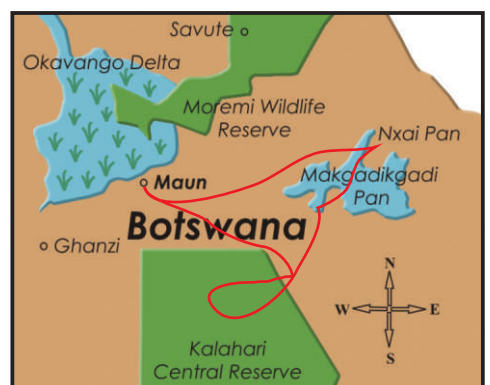

Authentic Safari

Botswana 10 Days

8 NIGHTS STANDARD MOBILE SAFARI WITH 1 NIGHT HOTEL ACCOMMODATION



Day 1: Maun Bush Camp

We are welcomed at Maun airport by our guide, taken to a local restaurant for a light lunch and then transferred to our camp near Maun. The first evening in the African bush is spent relaxing around the campfire under the bright stars of the southern hemisphere. Standard Mobile Safari **(Light lunch & dinner)**



Day 2 & 3: Okavango area of Moremi

The morning starts with a visit to a Cultural Village in the Sankuyo area of Moremi where we are shown the lifestyles & tradition of the Bayei tribe, before continuing with a leisure game drive into the Okavango area of Moremi. The next day the channels and waterways of the Okavango Delta are explored on a morning boat excursion, with lunch being enjoyed either back at camp or at a shady spot in the wilderness. Standard Mobile Safari **(All meals)**

Day 4 & 5: Khwai area of Moremi

After breakfast, we move our camp to the Khwai flood plains where during our afternoon and morning game drives; we explore the pristine wilderness in search of the many species of animals and birdlife that make Moremi their home. (Optional activity at own expense – 2 hour Mokoro excursion) Standard Mobile Safari **(All meals)**

Day 6, 7 & 8: Savute & Chobe National Park

Continuing overland through the National Parks we visit the dry Savute Marsh and Savute channel, famous for its abundance of large predators. This amazing area and its waterholes are explored during our early morning and late afternoon game drives with our guide. Chobe is famous for its beautiful scenery and magnificent sunsets, with the largest elephant population in Africa living in the region. We may witness huge herds during our game drives and an unforgettable game-viewing cruise on the Chobe River. Standard Mobile Safari **(All meals)**



Day 9: Livingstone / Victoria Falls

Our safari culminates at Livingstone / Victoria Falls, without a doubt one of the greatest and most unforgettable spectacles in Africa. Spend this time at our own leisure and enjoy the many optional activities on offer (at own expense). The Waterfront (or similar accommodation) **(Breakfast only)**



Day 10: Livingstone / Victoria Falls

The safari ends after Breakfast. (Breakfast)

The itinerary will depend on local conditions.

Transfers included:

MB – Road transfer from Maun Airport to camp on day 1
VF – Road transfer from Moremi to Maun Airport on day 10

Tour Code:

MB Maun to Livingstone
VF Livingstone to Maun

Itinerary - VF Tour Code Livingstone to Maun:

Day 1: Livingstone, The Waterfront (or similar accommodation). (Dinner)

Day 2, 3 & 4: Chobe National Park & Savute. (All meals, except Lunch on Day 2)

Day 5 & 6: Khwai area of Moremi. (All meals)

Day 7, 8 & 9: Okavango area of Moremi. (All meals)

Day 10: Cultural Village visit. Maun. Safari ends. (Breakfast)

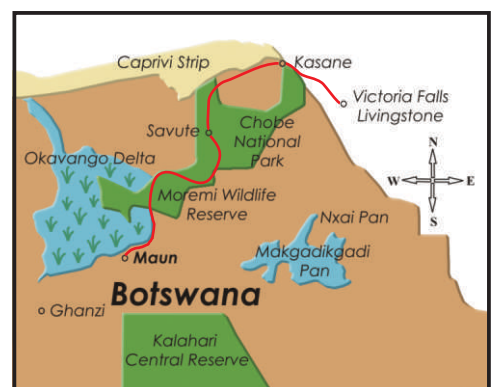

Okavango Safari

Botswana 6 Days

5 NIGHTS STANDARD MOBILE SAFARI



Day 2 & 3: Okavango area of Moremi

The morning starts with a visit to a Cultural Village in the Sankuyo area of Moremi where we are shown the lifestyles & tradition of the Bayei tribe, before continuing with a leisure game drive into the Okavango area of Moremi. The next day the channels and waterways of the Okavango Delta are explored on a morning boat excursion, with lunch being enjoyed either back at camp or at a shady spot in the wilderness. Standard Mobile Safari **(All meals)**



Day 1: Maun Bush Camp

We are welcomed at Maun airport by our guide, taken for a light lunch at a local restaurant and then transferred to our camp near Maun. The first evening in the African bush is spent relaxing around the campfire under the bright stars of the southern hemisphere. Standard Mobile Safari **(Light lunch & dinner)**



Day 4 & 5: Khwai area of Moremi

After breakfast, we move our camp to the Khwai flood plains where during our afternoon and morning game drives; we explore the pristine wilderness in search of the many species of animals and birdlife that make Moremi their home. (Optional activity at own expense – 2 hour Mokoro excursion) Standard Mobile Safari **(All meals)**

Day 6: Moremi - Maun

An early morning game drive takes us out of Moremi returning to Maun. Time permitting lunch can be enjoyed at a local restaurant (at own expense). Afterwards we transfer to the airport to board our onward flight. **(Breakfast only)**

Transfers Included:

Day 1: from Maun Airport

Day 6: to Maun Airport

Tour Code OK Maun to Maun

Game drives are guaranteed with window seats.

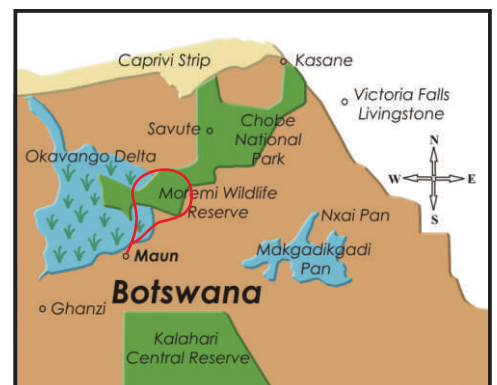

Desert and Delta Safari

Namibia & Botswana 17 Days

12 NIGHTS STANDARD MOBILE SAFARI WITH 4 NIGHTS HOTEL / LODGE ACCOMMODATION



DESERT- Day 1: Windhoek

Windhoek, with its lingering heritage of German architecture, activities and atmosphere, is a city that can be visited throughout the year. This day is spent at your own leisure. Hotel Safari (or similar accommodation) **(Dinner own arrangements)**

Day 2: Spitzkoppe

The Spitzkoppe is also described as the "Matterhorn of Namibia". Rising to an altitude of about 1800 meters, the Spitzkoppe, due to its striking outlines, it is regarded as the most well-known mountain in the country. Situated in an endless, dry plain, the island of mountains can be seen from far away. We enjoy one of the various walking trails available. Standard Mobile Safari **(All meals)**

Day 3: Swakopmund

Swakopmund, with its German colonial atmosphere, is the principal coastal resort of Namibia. Time is spent at own leisure to enjoy the charm of this old town or to undertake one of the many optional activities on offer e.g. quad biking, sand boarding, scenic flights (at own expense). Overnight accommodation in Bungalows **(Breakfast only)**

Day 4 & 5: Namib Desert - Sossusvlei

Our journey takes us to the heart of the Namib Desert. The following morning is an early departure for Sossusvlei stopping in the dune belt to enjoy the changing colours of the world's highest sand dunes. Spend the morning walking amongst the dunes of Sossusvlei and Deadvlei. On the way back to the camp we enjoy a short hike through Sesriem Canyon. Standard Mobile Safari **(All meals)**

Day 6: Gobabis

We depart after breakfast and arrive in Windhoek at lunchtime (lunch own account). We continue east into the Gobabis area, where we will set up the camp. Standard Mobile Safari **(Breakfast and Dinner only)**

Day 7: Ghanzi

We drive to Botswana and set up camp at a Bushman Village in the Kalahari. The local Bushmen community runs the project with all the proceeds directly benefiting the community. The following morning we venture out on a guided bush walk, with a local guide who will explain/show to us how the community sustains itself within this harsh environment. Standard Mobile Safari **(All meals)**

DELTA - Day 8: Maun

Continuing overland we are welcomed in Maun by our Botswana guide who hosts us at a local restaurant for lunch. We have the opportunity to do some shopping or take a scenic flight over the Okavango Delta (at own expense). Croc Camp Chalet accommodation (or similar) **(All meals)**

Day 9 & 10: Okavango Delta

After breakfast we head into the Delta where we explore the channels and waterways of the Okavango Delta on a boating excursion, visiting the natural "nursery" of the Heron. Standard Mobile Safari **(All meals)**

Day 11 & 12: Khwai

After breakfast, we move our camp to the Khwai flood plains where during our afternoon and morning game drives; we explore the pristine wilderness in search of the many species of animals and birdlife that make Moremi their home. (Optional activity at own expense – 2 hour Mokoro excursion) Standard Mobile Safari **(All meals)**

Day 13 & 14: Savute

Continuing overland through the National Parks we visit the dry Savute Marsh and Savute channel, famous for its abundance of large predators. Standard Mobile Safari **(All meals)**

Day 15: Chobe

Chobe is famous for its magnificent scenery and sunsets, with the largest elephant population in Africa living in the region. Standard Mobile Safari **(All meals)**



Day 16: Chobe to Livingstone

This morning we are treated to a morning boat cruise on the Chobe River, where we may witness huge herds, before being transferred across the border to Livingstone. In Livingstone we spend time at our own leisure and enjoy the many optional activities on offer (at own expense). Zambezi Waterfront Hotel (or similar accommodation) **(Breakfast only)**

Day 17: Livingstone

Over morning breakfast, we have the opportunity to exchange contact details with friends we have made during this adventure safari before leaving for the airport to journey back home. End of safari. **(Breakfast)**

Transfers Included:

Day 1: from airport in Windhoek

Tour Code: DD Windhoek to Livingstone only.

Trips from Maun to Livingstone are available on request.

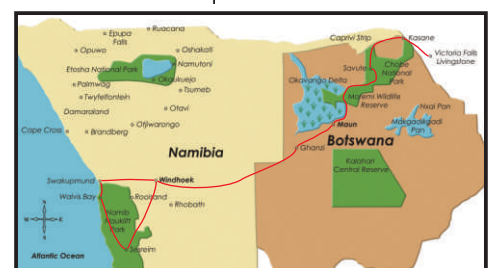

Stanley Safari

Botswana 10 Days

8 NIGHTS COMFORT MOBILE SAFARI WITH 1 NIGHT COMFORT LODGE ACCOMMODATION



Day 1: Maun - Okavango area of Moremi

After breakfast, we move our camp to the Khwai flood plains where during our afternoon and morning game drives; we explore the pristine wilderness in search of the many species of animals and birdlife that make Moremi their home. (Optional activity at own expense – 2 hour Mokoro excursion) Standard Mobile Safari **(All meals)**

Day 2: Okavango area of Moremi

Today we explore the channels and waterways of the Okavango Delta on a morning boat excursion. Lunch is served either back at camp or picnic style, with an afternoon game drive, taking in the changing colours of an African sunset. Comfort Mobile Safari **(All meals)**

Day 3 & 4: Khwai area of Moremi

After breakfast, our safari crew expertly moves our exclusive camp to the Khwai floodplains. During early morning and late afternoon game drives we search for the many species of animal and birdlife that make Moremi their home. (Optional activity at own expense – 2 hour Mokoro excursion) Comfort Mobile Safari **(All meals)**



Day 5 & 6: Savute - Chobe National Park

Continuing overland through the National Parks we visit Savute, famous for its abundance of large predators. We discover this amazing area and its waterholes during our early morning and late afternoon game drives. Comfort Mobile Safari **(All meals)**



Day 7 & 8: Chobe river - Chobe National Park

After 2 nights in Savute, we travel north and install our bush camp near the Chobe River. Chobe is famous for its beautiful scenery and magnificent sunsets. It is home to the largest elephant population in Africa. We may witness huge herds during our game drives or on our sunset cruise on the Chobe River. Comfort Mobile Safari **(All meals)**



Day 9: Victoria Falls

Today we are transferred out of Chobe area of Botswana and cross the border to our lodge accommodation in Zimbabwe, enroute we are treated to a tour of the Victoria Falls. The afternoon we have time at leisure to enjoy the many optional activities on offer. (own expense). Ilala Lodge (or similar accommodation) **(Breakfast & dinner)**
Lunch on day 9 own expense

Day 10: Victoria Falls

After breakfast our safari culminates. **(Breakfast only)**

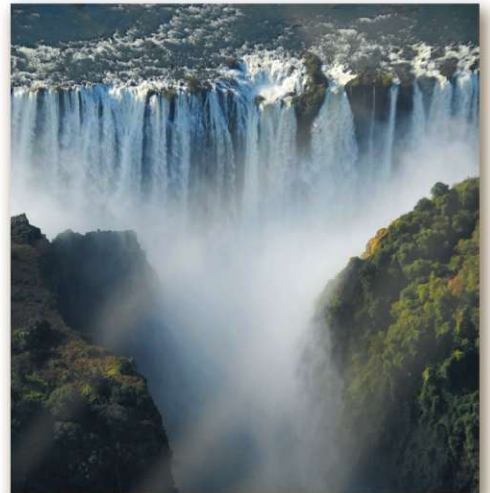

Transfers Included:

BS – Scenic charter flight transfer from Maun airport to Moremi on Day 1

Tour Code:

BS Maun to Victoria Falls

Game drives are guaranteed with window seats

Itinerary VS Tour Code – Victoria Falls to Maun

Day 1: Victoria Falls, Ilala Lodge (or similar) (Dinner)

Day 2 & 3: Chobe National Park. (All meals, except lunch on day 2)

Day 4 & 5: Savute – Chobe National Park. (All meals)

Day 6 & 7: Khwai area of Moremi (All meals)

Day 8 & 9: Okavango area of Moremi (All meals)

Day 10: Maun (Breakfast)

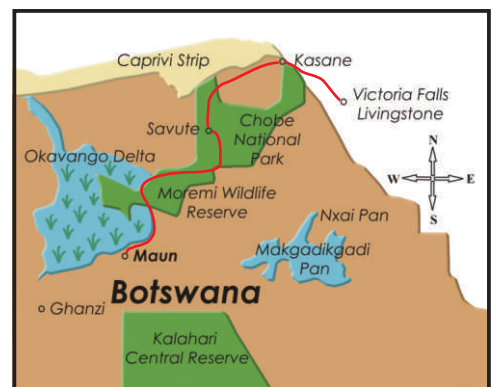

Classic Moremi Safari

Botswana 6 Days

4 NIGHTS COMFORT MOBILE SAFARI WITH 1 NIGHT COMFORT LODGE ACCOMMODATION



Day 1: Maun - Okavango Area of Moremi

On arrival in Maun we are hosted at a local restaurant for a light lunch. An air transfer then takes us from Maun into Moremi where we are met by our guide for a short transfer to our pre-erected secluded bush camp. After a sunset game drive and a delicious three-course dinner, the sounds of the African night are enjoyed. Comfort Mobile Safari **(Light Lunch & Dinner)**.



Day 2: Okavango area of Moremi

We explore the channels and waterways on a morning boat excursion. Lunch is served either back in camp or picnic style, with an afternoon game drive, taking in the changing colours of an African sunset. Comfort Mobile Safari **(All meals)**

Day 3 & 4: Khwai area of Moremi

After breakfast, our safari crew expertly moves our exclusive camp to the Khwai floodplains. During early morning and late afternoon game drives we search for the many species of animal and birdlife that make Moremi their home. (Optional activity at own expense – 2 hour Mokoro excursion) Comfort Mobile Safari **(All meals)**



Day 5: Tented Camp in concession area of Khwai

After breakfast, a leisure game drive transfers us to the concession Comfort tented lodge. The variety of bird species here will keep us enthralled. Late afternoon we have the opportunity to explore this concession area on a sundowner game drive. Hyena Pan bush Camp (or similar accommodation). **(All meals)**.



Day 6: Maun

After breakfast we are transferred from our tented camp back to Maun Airport. **(Breakfast)**



Transfers Included:

DAY 1: Scenic charter flight from Maun Airport to mobile camp in Moremi

DAY 6: Road transfer from Hyena Bush Camp (or similar accommodation) back to Maun Airport

Tour Code:

SM Maun to Maun

All game drives are guaranteed with window seats.

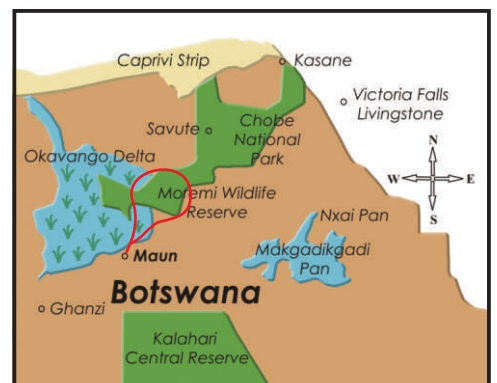

Lilies & Dust

Botswana 12 Days

COMBINATION SAFARI WITH 4 NIGHTS MOBILE CAMPING AND 2 NIGHTS COMFORT HOUSEBOAT AND 5 NIGHTS COMFORT TENTED LODGE ACCOMMODATION



Day 1: Gcadikwe Island Camp **Okavango area of Moremi**

On arrival in Maun we are hosted at a local restaurant for a light lunch. An air transfer then takes us from Maun into Moremi where we are met by our guide and road transferred to Xakanaxa boat station having the opportunity to view the wildlife en-route. A boat excursion takes us into the Okavango channels and lagoon areas en-route to our pre-erected mobile camp on an Island. Here we have the chance of seeing hippos, crocodiles and the birdlife endemic to the area. A delicious three-course dinner is served with the sounds of the African night as our serenade. Mobile camping (**Light Lunch & Dinner**).



Day 2: Gcadikwe Island Camp **Okavango area of Moremi**

Today we have the opportunity to further explore the channels and waterways of the Okavango Delta by boat, with lunch being enjoyed either back at camp or at a shady stop on one of the Islands. Mobile Camping (**All meals**)



Day 3: Hyena Pan Camp

Khwai concession area

After a hearty breakfast expertly cooked on an open fire we are boated back to the boat station to our game vehicle. Lunch is enjoyed picnic style en-route to our concession comfort tented camp situated outside the gates of the Moremi Game Reserve, voted the best Game Reserve in the World. There are no fences between the Park and the private concession making our night drive even more fantastic...

Hyena Pan Camp (or similar accommodation) (**All meals**)

Day 4: Hyena Pan Camp

Khwai concession area

This morning our guide takes us exploring the Khwai floodplains and the serenity of the surrounding wilderness is overpowering. (Optional activity at own expense – 2 hour Mokoro excursion). Hyena Pan Camp (or similar accommodation) (**All meals**)

Day 5: Crocodile Camp - Maun

An early morning breakfast before our road transfer / game drive takes us into Maun and onto our lodge accommodation. This lodge is situated on the banks of the Thamalakane river, 12km outside of Maun. This camp hosts an abundance of bird life with the occasional hippo or crocodile visitor. A sundowner boat cruise on the river rounds off our day. Crocodile Camp (or similar accommodation) (**All meals**)



Day 6: Ngwesi Houseboat **Okavango River**

We are road transferred to Maun airport, where we meet our charter flight for the onward journey into the panhandle of the Okavango. Capture the rhythms of the Delta and feel the heartbeat of the mighty Okavango in Botswana as you journey on the Ngwesi Houseboat. Once on board we will up anchor and move out onto the river, dropping anchor in the late afternoon. Sundowners are served as we marvel at the African sunset. Ngwesi Houseboat (or similar accommodation) (**All meals**)



Lilies & Dust

Day 7: Ngwesi Houseboat Okavango River

En suite accommodation is offered in cabins on the lower deck. Activities include birding - with over 400 species of birds this area is one of the top bird watching spots in the world. Try your hand at the sport of Tiger and Bream fishing - excursions are offered on tender boats to explore the Delta with its countless water channels. Ngwesi Houseboat (or similar accommodation) **(All Meals)**



Day 8 & 9: Central Kalahari Game Reserve - Deception Valley

Early morning the Ngwesi pulls up anchor and meanders back to its mooring, with breakfast being served en route. We are then taken back to the airstrip where a charter flight takes us to the unique and untamed Central Kalahari Reserve. Here we will explore the area around Deception Valley, looking for the large herds of antelope that inhabit this desert terrain. Sightings of predators are common as they lie in wait, watching the antelope. Mobile Camping **(All meals)**



Day 10: Haina Kalahari Lodge northern border of Central Kalahari Game Reserve

Today we are road transferred by our guide to our lodge, a classically African, relaxed and informal safari tented lodge. Enjoy sundowners and dinner before taking a night drive to explore the magic of the nocturnal creatures in the area. Haina Kalahari Lodge (or similar accommodation) **(All meals)**



Day 11: Haina Kalahari Lodge northern border of Central Kalahari Game Reserve

A guided walk with our experienced guide unfolds the tracks and signs of the wilderness. We also get to experience the magic and culture of the Bushman as they show us their world of survival in the desert. Haina Kalahari Lodge (or similar accommodation) **(All meals)**



Day 12: Maun

An early rise will take us on our last memorable game drive, before breakfast. A scenic flight transfers us back to Maun airport. **(Breakfast)**

The itinerary will depend on local conditions.

Transfers Included:

Charter flights on Day 1, Day 6, Day 8 and Day 12

Road transfer on Day 3, Day 5 and Day 10

TOUR CODE:

LD Maun to Maun

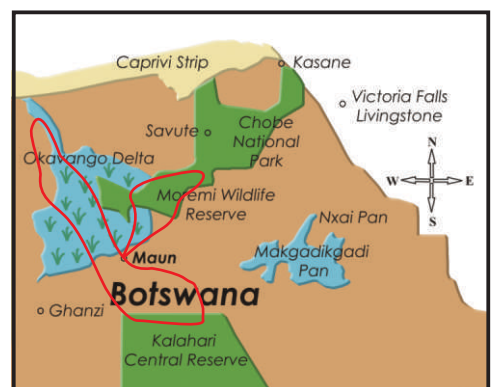

Unique Wilderness

Botswana 11 Days

6 NIGHTS COMFORT MOBILE SAFARI WITH 4 NIGHTS COMFORT TENTED ACCOMMODATION



Day 1: Kasane - Chobe National Park

On our arrival at Kasane airport we are welcomed and escorted to our Safari vehicle which will road transfer us to our mobile bush camp in Chobe National Park. The first evening in the African bush is spent relaxing around the campfire under the bright stars of the southern hemisphere. Comfort mobile safari **(Light lunch & dinner)**



Day 2: Chobe River,

Chobe National Park

Chobe is famous for its beautiful scenery and magnificent sunsets, with the largest elephant population in Africa living in the region. We may witness huge herds during our game drives and an unforgettable game viewing boat cruise on the Chobe River. Comfort mobile safari **(All meals)**.



Day 3 & 4: Savute

Chobe National Park

Continuing overland through the National Parks we visit the dry Savute Marsh and Savute channel, famous for its abundance of large predators. This amazing area and its waterholes are uncovered during our early morning and late afternoon game drives with our guide. Comfort mobile safari **(All meals)**.



Day 5 & 6: Hyena Pan Camp

Khwai concession area

After breakfast, a game drive transfers us to our concession tented camp in the Khwai area. The serenity of the surrounding wilderness is overpowering as this Comfort tented accommodation places one in the midst of Africa's most significant game and a night under the African sky will never be the same again. (Optional activity at own expense – 2 hour Mokoro excursion) Hyena Pan Camp (or similar accommodation). **(All meals)**.

Day 7 & 8: Gcadikwe Island

Okavango area of Moremi

Our guide road transfers us in our game viewer to Xakanaxa boat station having the opportunity to view the wildlife en-route. A boat excursion takes us into the Okavango channels and lagoon areas en-route to our pre-erected mobile camp on an Island. Here we have the chance of seeing hippos, crocodiles and the birdlife endemic to the area. A delicious three-course dinner is served with the sounds of the African night as our serenade. Comfort mobile safari **(All meals)**.



Day 9 & 10: 3rd Bridge Tented

Camp – Western Xakanaxa area of Moremi

After a hearty breakfast expertly cooked on an open fire we are boated back to the boat station to our game vehicle. Leisure game drive transfers us to our next comfort tented camp. The variety of bird species here will keep us enthralled. Late afternoon we have the opportunity to explore the area on a sundowner game drive. 3rd Bridge Tented Camp (or similar tented accommodation). **(All meals)**.

Day 11: Maun

This morning we depart after a hearty breakfast back to Maun Airport. **(Breakfast)**.

Transfers Included:

Day 1: Road transfer from Kasane airport to mobile bush camp in Chobe National Park

Day 11: Road transfer from tented accommodation to Maun airport

TOUR CODE: UW Kasane to Maun

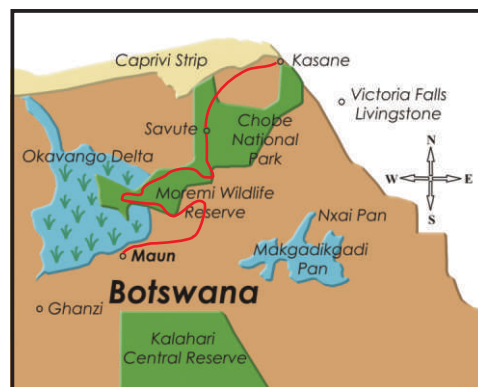



Affordable Comfort Lodging



HAINA KALAHARI LODGE

Central Kalahari Botswana

Haina Kalahari Lodge, a classic 4-star African-style lodge on the Northern border of the Central Kalahari Game Reserve, delights with relaxed and informal comfort. The welcoming thatched-roof lounge, dining and bar area which overlooks the water-hole or pool deck is a perfect oasis to relax and rejuvenate. Each safari tent is privately positioned on raised wooden decks with en-suite facilities.



COMFORT TENTS

- Room Layout - twin beds with full bed linen
- En-suite bathroom with shower, toilet and hand basin
- Towels provided
- Daily housekeeping
- Laundry services are available

LUXURY TENTS

- Room Layout - king size beds with full bed linen
- Open-plan bathroom with double hand basins, feature bath, separate toilet and shower
- Towels provided
- Daily housekeeping
- Laundry services are available



INCLUSIVE ACTIVITIES ON OFFER

- Morning and afternoon game drives
- Guided walks
- Bushman experience

OPTIONAL ACTIVITIES ON OFFER

- Night drives
- Quad bike game drives
- Excursions into Central Kalahari Game Reserve and Makgadikgadi Salt Pans



• MEALS

- Delectable set menu's
- Tea & coffee and beverages available

Ngwesi Houseboat, moored on the panhandle of the Okavango delights with intimate cabins accommodating 8 guests in 4 en-suite rooms on the lower deck. The upper deck being the ideal retreat to be mesmerised by the early morning sunrise or marvel at an African sunset as we capture the rhythms of the Delta. Your private paradise completed by fine dining and personal attention. The untouched water wilderness of the Okavango River is ideal for quiet self-discovery, enhanced only by the magical sights and sounds of the birds and wildlife.



COMFORT CABINS

- Cabin layout - 2 with twin beds & 2 with double beds, all with full bed linen
- En-suite bathroom with shower, toilet and hand basin
- Towels provided
- Daily housekeeping
- Limited laundry services available

INCLUSIVE ACTIVITIES ON OFFER

- Excursions are offered on tender boats to explore the countless Delta channels.
- Birding - with over 400 species, this area is one of the top bird watching spots in the world
- Try your hand at the sport of Tiger and Bream fishing





Crocodile Camp, picturesquely situated on the banks of the Thamalakane River and is our recommended accommodation when staying in Maun. A mere 12km from Maun airport, yet one still experiences the abundance of birdlife and has the occasional hippo or crocodile visitor. The chalets are river facing and residents can leisure the day away around the sparkling pool, admire spectacular sunsets over sundowners from the welcoming bar deck, ending the day with a scrumptious A la Carte meal served in the quaint restaurant.



STANDARD CHALETS

- Room Layout - twin beds with full bed linen
- En-suite bathroom with shower, toilet and hand basin
- Towels provided
- Daily housekeeping
- Laundry services are available



COMFORT CHALETS

- Room Layout - twin beds with full bed linen and comfortable seating area
- Spacious en-suite bathroom with hand basin, open-plan shower and separate toilet
- Towels provided
- Daily housekeeping
- Laundry services are available



OPTIONAL ACTIVITIES ON OFFER

- Boat excursion, day trips or sunset cruises
- Mokoro trips
- Horse riding in surrounds of Maun
- Scenic flights over the Okavango Delta
- Easy access to Moremi Game Reserve and The Okavango Delta



Safari Add-on's

Enhance your planned itinerary in Botswana with one of our highly recommended "Safari-Add on's"

Take a Walk on the Wild side

Spend a night or two at Hyena Pan Camp and have an experienced guide take you on an informative walk in the wilderness.



Kalahari Magic

Spend at least two nights in the vast and untamed Kalahari. Experience the magic and culture of the Bushman as they walk you into an unbelievable world of survival in the desert. Then settle down and be pampered by your hosts at Haina Kalahari Lodge.

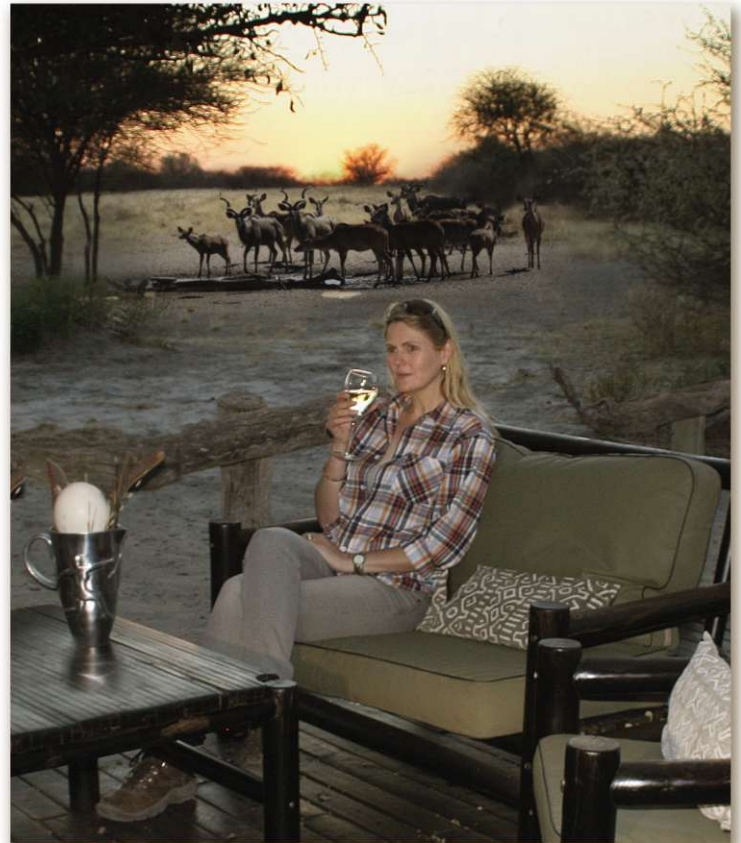

Explore the Waterways

Explore the channels and waterways of the Okavango Delta by motorboat from within Moremi Game Reserve. Spend a night or two in comfort style camping on an Island.



Gone Fishing

Fly fish the waters of the Okavango River in the North of the Delta from the comfort of Ngwesi Houseboat. Visit Tsodilo Hills and perhaps partake in some traditional basket weaving.



karibu
safari
BOTSWANA

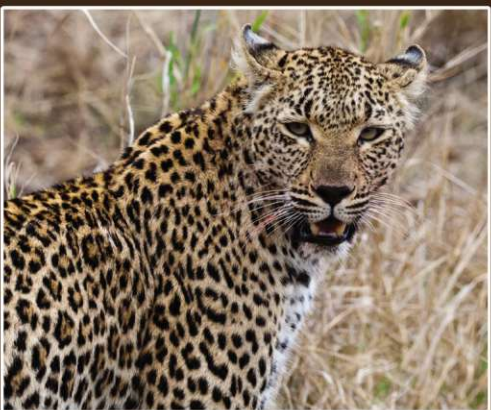

Agents Details

CENTRAL RESERVATIONS
Botswana
Tel: +267 686 1225
E-mail: karibubots@info.bw
www.karibu.co.za